

**Presentation of Rajasthan State
for
Sanction by
Central Sanctioning & Monitoring
Committee Under Housing for All**



Dated: 30th October, 2017

**Local Self Government Department
Government of Rajasthan**

RUDSICO



CMJAY- 2015



Progress of Projects Approved by CSMC, Affordable Housing in Partnership (AHP)

Dt.30.10.2017

S.N.	Total Project Sanctioned	Total Project Started	No of Dwelling Units	No of Dwelling Units taken up	Work Awarded	Bids in Process	Bids Invited
1.	37	21	20695	10696	15	00	01#

Progress of Projects Approved by CSMC, Beneficiary led construction (BLC)

S.N.	Total Project Sanctioned	No of Dwelling Units	Dwelling Units Started
1.	1	180	45

Jahazpur



Progress (HFA PoA & AIP)

Indicators	Current Status
No. of Cities Approved	183
No. of Cities where demand survey completed	22
Timeline for completion of demand survey in remaining cities/towns if any	Nov. 2017
Total demand assessed (30 Sep. 2017)	151427
No. of HFAPoA & AIP prepared/submitted	22
Time for submission of HFAPoA & AIP for all approved cities/towns	Dec.2017
Targets of DUs in 2017-18	75000
Budgetary provision of fund in 2017-18	250 Cr.



Progress of projects, sanctioned by CSMC

S.No.	Project Details	Houses Sanctioned	Houses taken up	Up to plinth level	Up to ground floor roof laid	Up to first floor roof laid	Up to second floor roof laid	Up to third roof laid
1	Dholi Magri, Bedwas, Udaipur	848	848	848	160	152	152	152
2	Gram Anganwa Sunder Singh Bhandari Nagar, Jodhpur	544	544	480	128	104	80	80
3	Khasra No. 698 & 699 Ashoka Road Near Housing Board Balotra (Phase-I)	608	608	608	152	152	152	152
4	Khasra No. 698 & 699 Ashoka Road Near Housing Board Balotra (Phase-II)	592	398	288	72	72	72	72





Progress of projects, sanctioned by CSMC

S.No.	Project Details	Houses Sanctioned	Houses taken up	Up to plinth level	Up to ground floor roof laid	Up to first floor roof laid	Up to second floor roof laid	Up to third roof laid
5	Khasra No. 2012 behind Police Thana, BSNL, Falna	480	328	328	64	64	64	48
6	Affordable Housing Project in Bhadhana Scheme, Kota	252	252	72	0	0	0	0
7	Mohan LalSukhadia Scheme, Kota	368	368	336	64	60	60	60
8	Ranpur Scheme, Kota	320	300	200	0	0	0	0





Progress of projects, sanctioned by CSMC

S.No.	Project Details	Houses Sanctioned	Houses taken up	Up to plinth level	Up to ground floor roof laid	Up to first floor roof laid	Up to second floor roof laid	Up to third roof laid
9	Affordable Housing Project, Chittorgarh	304	304	304	60	20	16	0
10	Affordable Housing Project, Kishangarh	714	714	160	40	28	28	0
11	Affordable Housing Project, Bhilwara	604	604	224	0	0	0	0
12	Affordable Housing Project, MLS, Kota	532	532	532	128	102	100	100
13	Affordable Housing Project, Prem Nagar	368	368	368	92	92	92	92
14	Affordable Housing Project, SCS, DCM Road.	640	640	640	160	160	160	160
15	Affordable Housing Project, Udaipur	640	640	80	0	0	0	0



Progress of projects, sanctioned by CSMC

S.No.	Project Details	Houses Sanctioned	Houses taken up	Up to plinth level	Up to ground floor roof laid	Up to first floor roof laid	Up to second floor roof laid	Up to third roof laid
16	Affordable Housing Project, Jodhpur	400	400	0	0	0	0	0
17	Affordable Housing Project, Dungarpur	272	272	32	0	0	0	0
18	Affordable Housing Project, Sheoganj	256	256	0	0	0	0	0
19	Affordable Housing Project, Sirohi.	400	400	0	0	0	0	0
20	Affordable Housing Project, Lordi Pandit (Pkg 09), Jodhpur	1008	1008	0	0	0	0	0
21	Affordable Housing Project, Lordi Pandit (Pkg 10), Jodhpur	912	912	0	0	0	0	0
	Total	11062	10696	5500	1120	1006	976	918



Progress of AHP projects sanctioned by CSMC

Photograph of Anganwa Jodhpur





Progress of AHP projects sanctioned by CSMC

Photograph of Falna (Pali)





Progress of AHP projects at Kota sanctioned by CSMC

Photograph of Kishangarh (Ajmer)





Progress of AHP projects at Kota sanctioned by CSMC



Photograph Project of Kota



Progress of AHP projects at Bedwas, Udaipur sanctioned by CSMC



Detail of Projects Submitted for approval

S.N	Name of Project	EWS Units	LIG Units
1.	Affordable Housing Project at Barli, Jodhpur by Jodhpur Development Authority.	2128	1024
2.	Affordable Housing Projects at Tanwara (Ph-II), Jodhpur by Jodhpur Development Authority.	512	320
3.	Affordable Housing Project at Beawar Khas , Ajmer by Municipal Council Beawar.	848	368
4.	Affordable Housing Project at Rajsamand by Municipal Council Rajsamand.	608	464
5.	Affordable Housing Project at Pali by Municipal Council Pali.	688	368
6.	Affordable Hosuing Project at Nimbahera, Chittorgarh by Municipal Board Nimbahera.	752	480
	Total	5536	3024



Project – 1 : Affordable Housing Project at Vill –Barli, Jodhpur

- Location – Village Barli, Khasra no. 88, Jodhpur
- Total Land Area – 12.148 Hac. (Govt. Land)
- Topography – Plain
- Land Area for EWS/LIG component - 9.11 Hac (75%)
- No of Units – EWS – 2128 units (67.51 % > 35% as per HFA)
LIG – 1024 units
Total – 3152 units
- Unit Built up area of EWS – 30.22 sqm. i.e 325.23 sq.ft.
- Sale price of EWS – 325.23 @Rs 1200/- per sqft (Rs 3.90 Lakhs)
- Subsidy by Implementing Agency– 325.23 sqft. @Rs. 477.21 /- per sqft
i.e Rs. 1.55 Lakhs
- **Per unit cost to be paid by beneficiary-Rs.2.4 Lakhs after AHP subsidy**
- Unit area of LIG – 500.04 Sqft. @Rs 1200/- per sqft (Rs 6.00 Lakhs)
- Status - Project approved by Local Authority & SLSMC.



Project - 1 : Affordable Housing Project at Vill - Barli , Jodhpur



Layout Plan



Project - 2 : Affordable Housing Project at Tanwara, Phase-II, Jodhpur.

LOCATION MAP OF LORDI PANDITJI

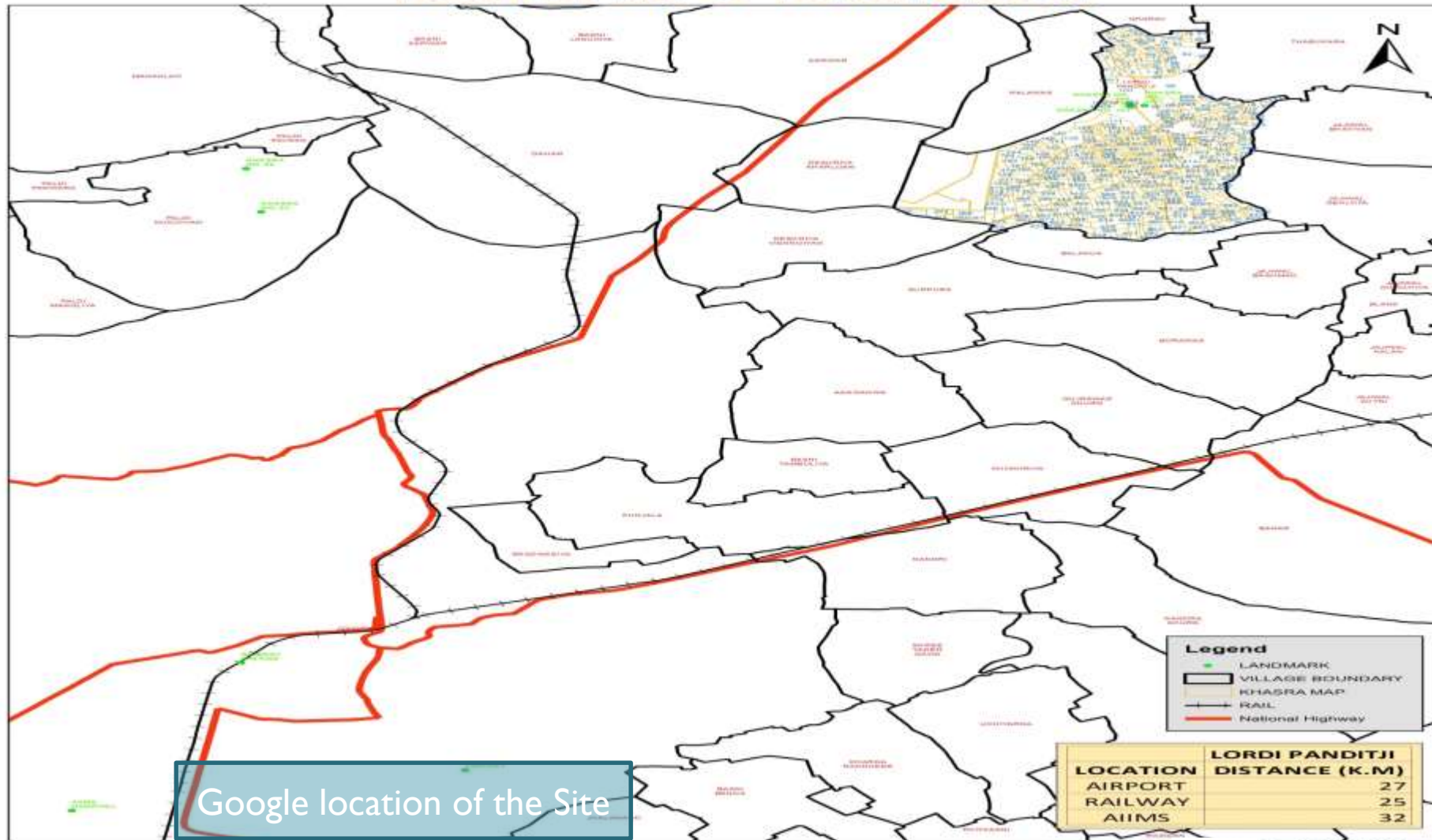

Google location of the Site

LOCATION	LORDI PANDITJI DISTANCE (K.M)
AIRPORT	27
RAILWAY	25
AIIMS	32





Project – 2 : Affordable Housing Project at Tanwara, Phase-II, Jodhpur.

- Location Plot no. Village Tanwara, Jodhpur
- Total Land Area – 3.484 Hac. (Govt. Land)
- Topography – Plain
- Land Area for EWS/LIG component - 2.613 Hac (75%)
- No of Units – EWS – 512 units (61.53% > 35% as per HFA)
LIG – 320 units
Total – 832 units
- Unit Builtup area of EWS – 30.20 sqm. i.e 325.00 sq.ft.
- Sale price of EWS – 325.00 @Rs 1200/- per sqft (Rs 3.90 Lakhs)
- Subsidy by Implementing Agency– 325.00 sqft. @Rs. 1006.48/- per sqft i.e Rs. 3.27 Lakhs
- **Per unit cost to be paid by beneficiary -Rs.2.40 Lakhs after AHP subsidy**
- Unit area of LIG – 500 Sqft. @Rs 1200/- per sqft (Rs 6..00 Lakhs)
- Status - Project approved by Local Authority & SLSMC.



Project - 2 : Affordable Housing Project at Tanwara, Phase-II, Jodhpur.

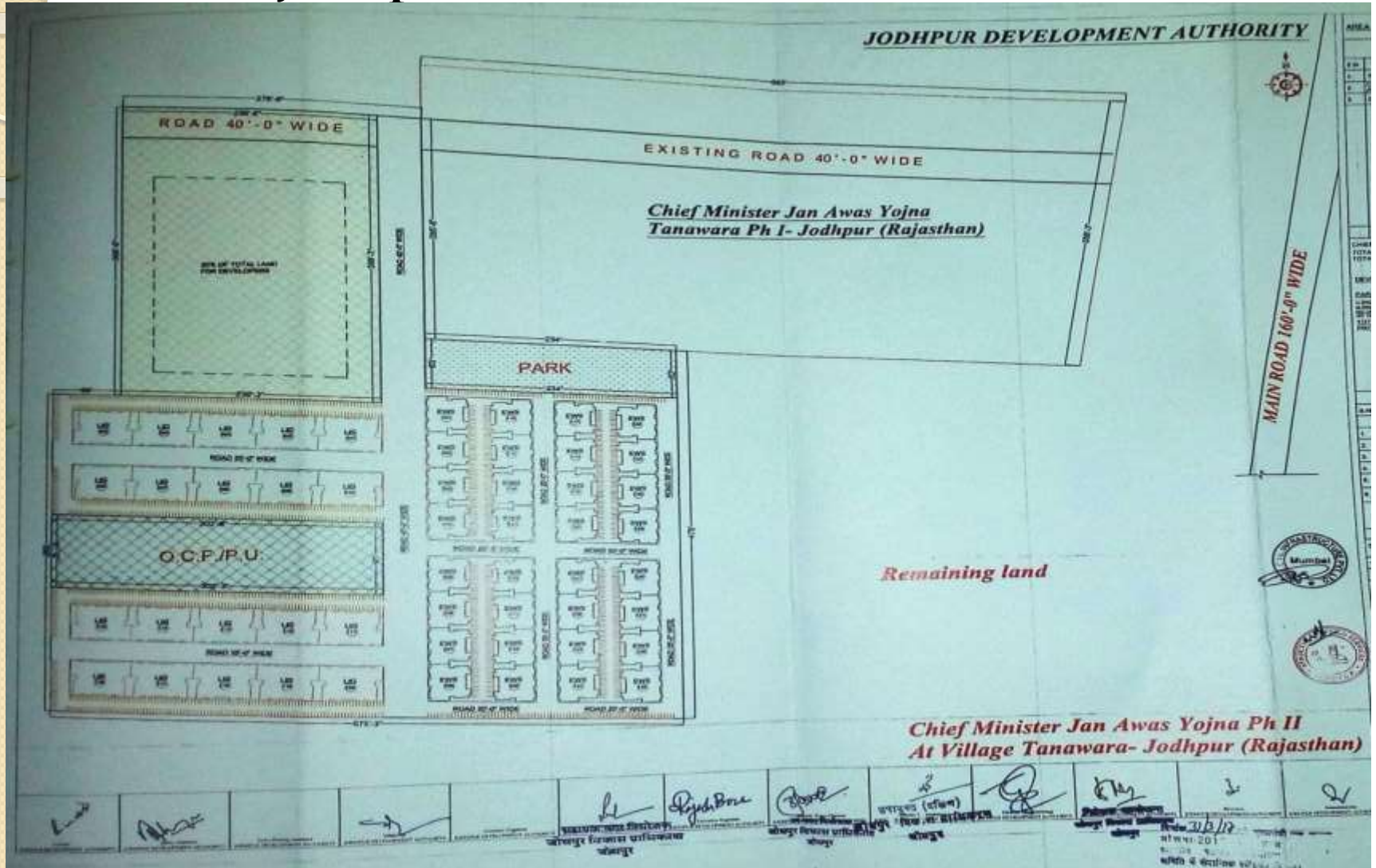

Layout Plan



Project - 3 : Affordable Housing Project at Beawar, Ajmer.





Project – 3 : Affordable Housing Project at Beawer Khas, Ajmer.

- Location – **Beawer Khas, Ajmer**
- Total Land Area 4.68 Hac. (Govt. Land)
- Topography – Plain
- Land Area for EWS/LIG component - 3.51 Hac (75%)
- No of Units – EWS – 848 units (69.73% > 35% as per HFA)
LIG – 368 units
Total – 1216 units
- Unit Built up area of EWS – 30.24 sqm. i.e 325.39 sq.ft.
- Sale price of EWS – 325.39@Rs 1200/- per sqft (Rs 3.90 Lakhs)
- Subsidy by Implementing Agency– 325.39 sqft. @Rs. 1.66/- per sqft i.e Rs. 0.054 Lakhs
- **Per unit cost to be paid by beneficiary- Rs. 2.40 Lakhs after AHP subsidy**
- Unit area of LIG – 500.81 Sqft. @Rs 1200/- per sqft (Rs 6.00 Lakhs)
- Status - Project approved by Local Authority & SLSCMC.



Project - 3 : Affordable Housing Project at Beawar Khas, Ajmer layout plan

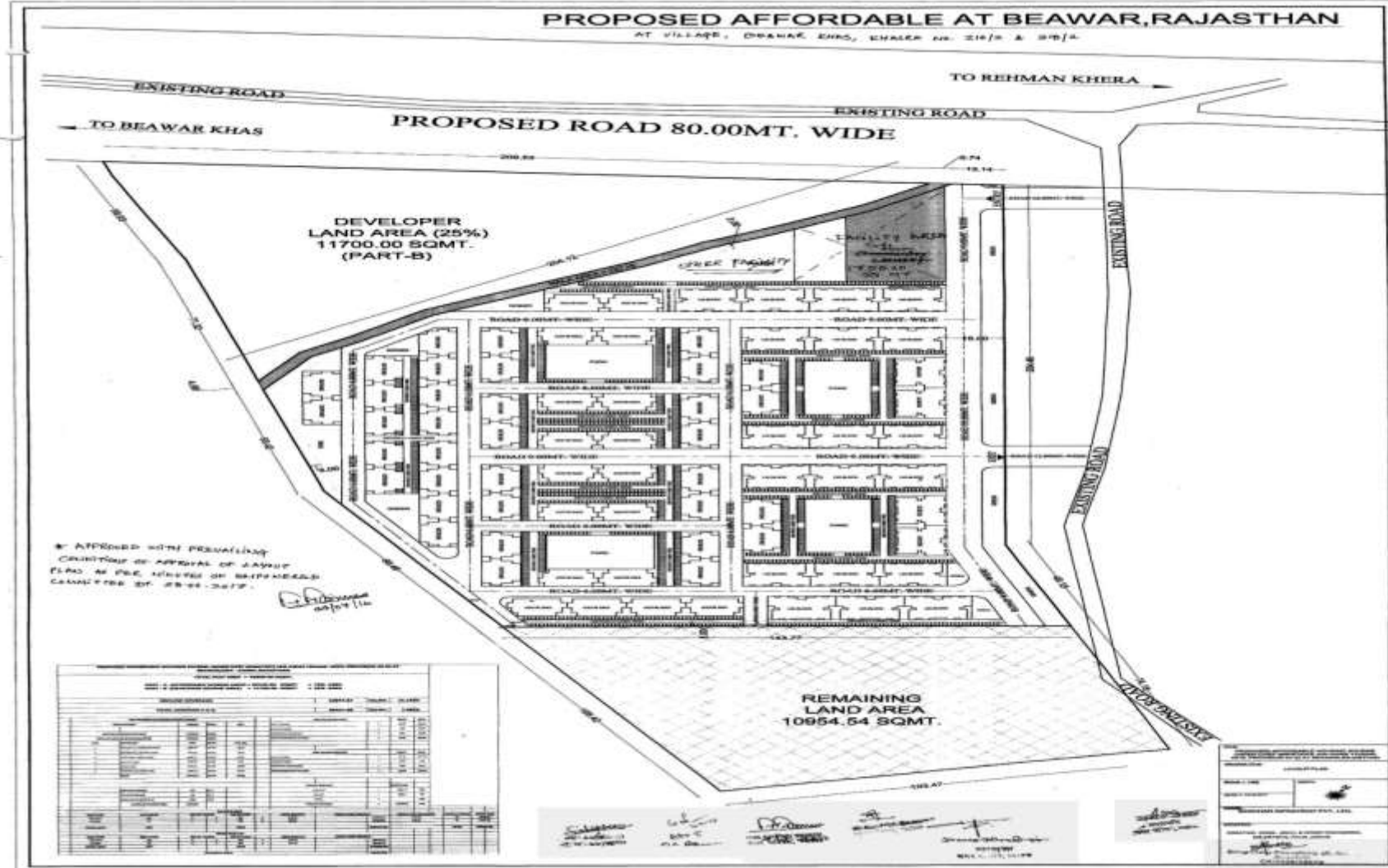



Project - 4: Affordable Housing Project at Rajsamand

- Location - **Rajsamand**
- Total Land Area 4.00 Hac. (Govt. Land)
- Topography - Plain
- Land Area for EWS/LIG component - 3.00 Hac (75%)
- No of Units - EWS - 608 units (56.71% > 35% as per HFA)
LIG - 464 units
Total - 1072 units
- Unit Built up area of EWS - 30.85 sqm. i.e 331.95 sq.ft.
- Sale price of EWS - 331.95@Rs 1200/- per sqft (Rs 3.98 Lakhs)
- Subsidy by Implementing Agency- 331.95 sqft. @Rs.286.00/- per sqft i.e Rs. 0.95 Lakhs
- **Per unit cost to be paid by beneficiary- Rs. 2.48 Lakhs after AHP subsidy**
- Unit area of LIG - 532.92 Sqft. @Rs 1200/- per sqft (Rs 6.39 Lakhs)
- Status - Project approved by Local Authority & SLSCMC.



Project - 4 : Affordable Housing Project at Rajsamand.

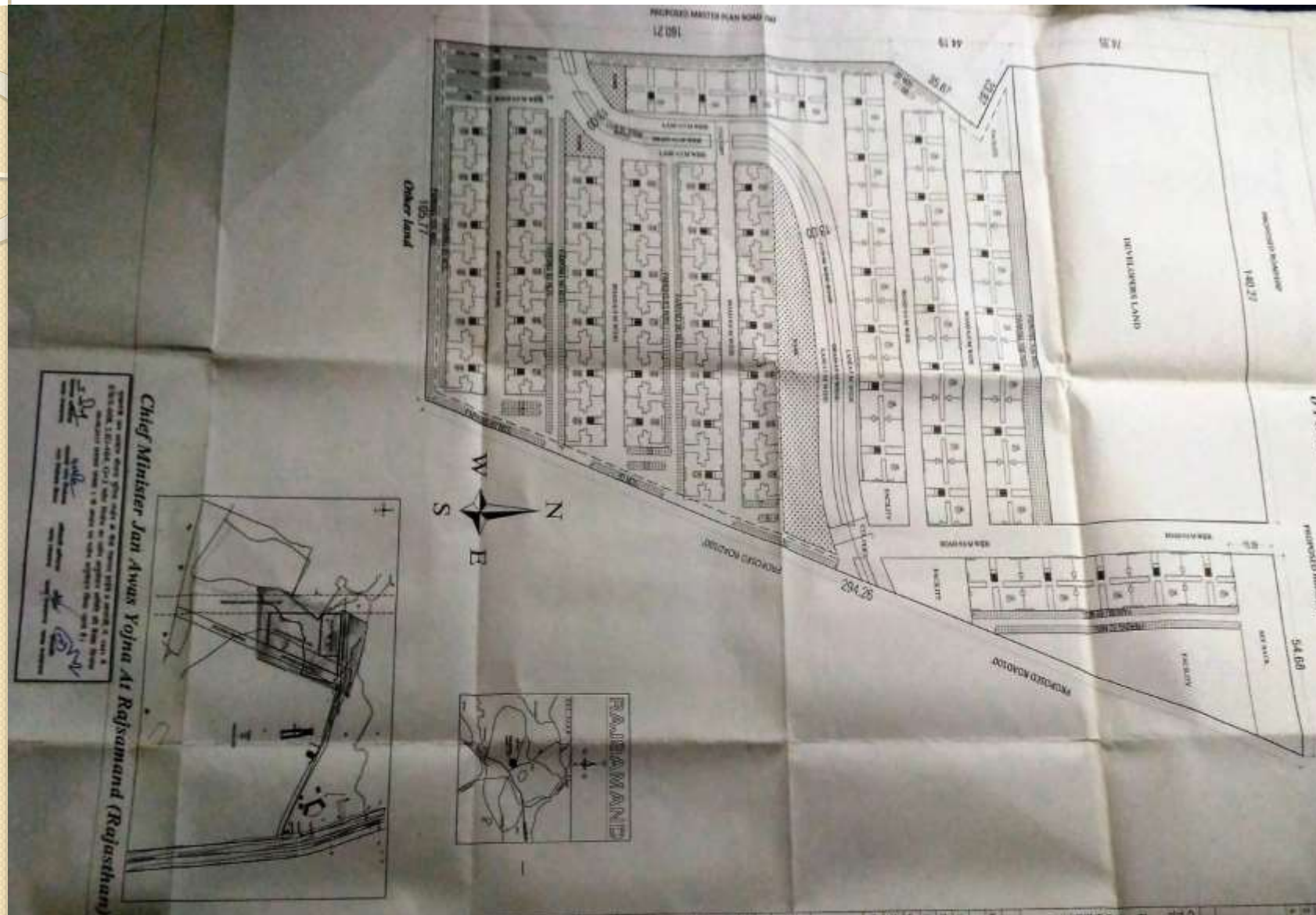

Layout Plan



Project - 5 : Affordable Housing Project at Pali

- Location - **Pali**
- Total Land Area -4.00 Hac. (Govt. Land)
- Topography - Plain
- Land Area for EWS/LIG component - 3.00 Hac (75%)
- No of Units - EWS - 688 units (65.15% > 35% as per HFA)
LIG - 368 units
Total - 1056 units
- Unit Built up area of EWS - 32.49 sqm. i.e 349.61 sq.ft.
- Sale price of EWS - 349.61@Rs 1200/- per sqft (Rs 4.19 Lakhs)
- Subsidy by Implementing Agency- 349.61 sqft. @Rs.918.67/- per sqft i.e Rs. 3.21 Lakhs
- **Per unit cost to be paid by beneficiary- Rs. 2.69 Lakhs after AHP subsidy**
- Unit area of LIG - 528.40 Sqft. @Rs 1200/- per sqft (Rs 6.34 Lakhs)
- Status - Project approved by Local Authority & SLSCMC.



Project - 5 : Affordable Housing Project at Pali.

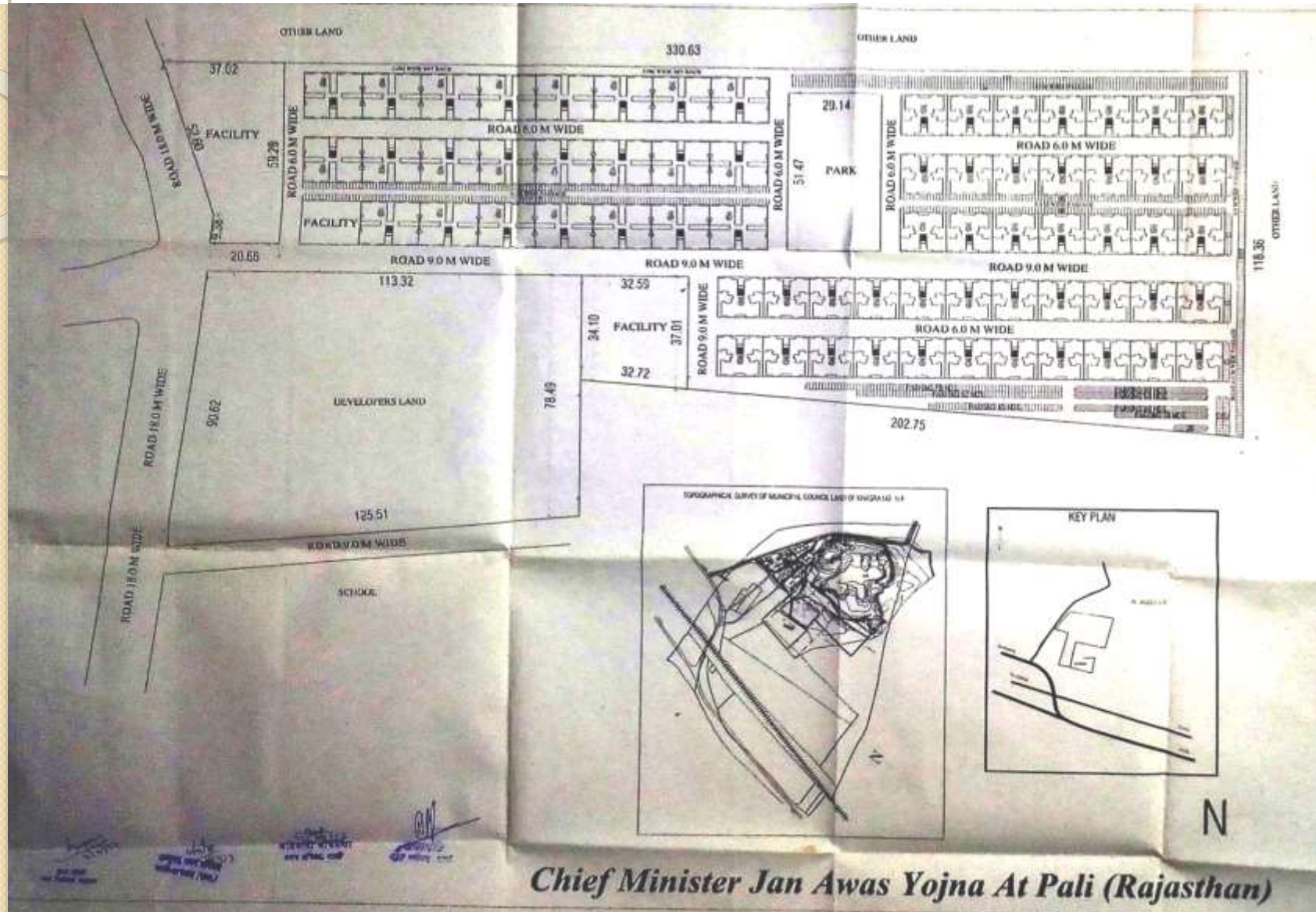

Layout Pali

RUDSICO



CMJAY2015



Project – 6 : Affordable Housing Project at Nimbahera, Chittorgarh

- Location - Nimbahera.
- Total Land Area -4.75 Hac. (Govt. Land)
- Topography - Plain
- Land Area for EWS/LIG component - 3.56 Hac (75%)
- No of Units - EWS - 752 units (61.03% > 35% as per HFA)
LIG - 480units
Total - 1232 units
- Unit Built up area of EWS - 30.22 sqm. i.e 325.20 sq.ft.
- Sale price of EWS - 325.20 @ Rs 1200/- per sqft (Rs 3.90 Lakhs)
- Subsidy by Implementing Agency- 325.20 sqft. @ Rs.107.74/- per sqft i.e Rs. 0.35 Lakhs
- **Per unit cost to be paid by beneficiary- Rs. 2.55 Lakhs after AHP subsidy**
- Unit area of LIG -500.00 Sqft. @Rs 1200/- per sqft (Rs 6.00 Lakhs)
- Status - Project approved by Local Authority & SLSMC.



Project - 6 : Affordable Housing Project at Nimbahera, Chittorgarh



Satellite image

Google location of the Site



Project - 6 : Affordable Housing Project at Nimbahera, Chittorgarh. (Layout Plan)

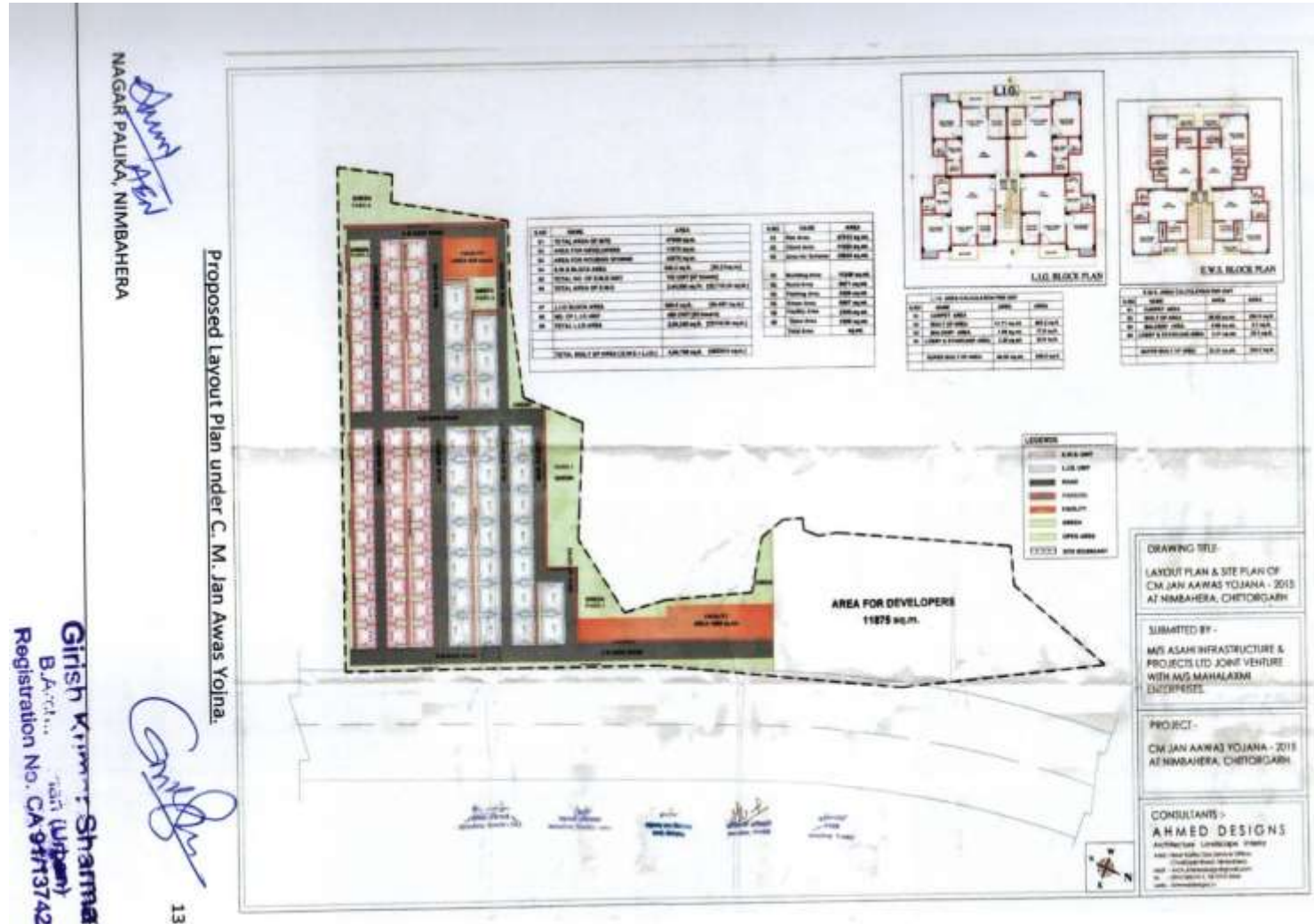

2.3.6 The layout of said project and approximate shape of the subject property is shown below in the proposal drawing issued by the UIT.

Thank
you!



RUDSICO



CMJAY- 2015